

Voltage Current Rating: 5 AMP.
 Dielectric Withstanding Voltage: 1000V AC
 Insulation Resistance: 1000MΩ Min.
 Temperature Range: -25°C to +85°C

PART NO: B05-0504X1AN-01

HOUSING COLOR: _____
 1 = BLACK
 5 = WHITE
 6 = BLUE

∅3.05 Clear hole

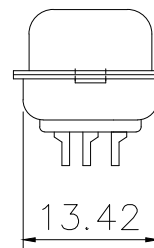
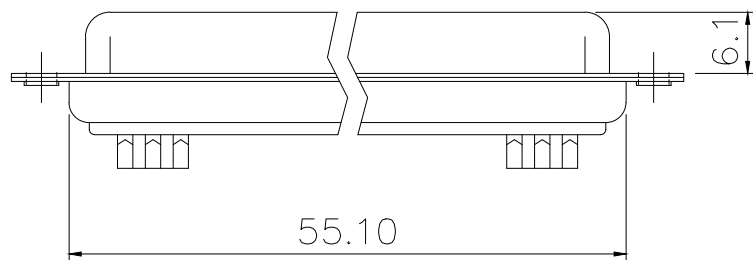

50 Positions

4	REAR SHELL	SPCC	PALTING: Sn	
3	FRONT SHELL	SPCC	PALTING: Ni	
2	HOUSING	PBT+30%GF	COLOR: SEE PART NO.	
1	TERMINAL	COPPER ALLOY	CONTACT AREA: G/F SOLDER AREA: Sn	
ITEM	DESC.	MATERIAL	REMARKS	PART REMARKS

QUALITY SYMBOLS

□: ☒: CRITICAL MAJOR
 ▼: ▽: ZERO DEFECT S.P.C

Tolerance

x. ±0.50
 .x ±0.30
 .xx ±0.25

NAME: D-SUB 50P母头传统焊线式 (客户用图) PART NO. B05-0504X1AN-01

REV: A UNIT: mm DRW BY: KING ZHOU CHK BY: APP BY: DRAWING NO. B05-020

SCALE: N:1 DATE: 2010/06/03 JINGLI KING ZHOU

lineconn 东莞市林诚塑胶电子有限公司 http://www.lineconn.com
 TEL: 0769-85181660 85181770

△	2010/06/03	NEW ISSUE	JINGLI
SIDE	DATE	DESCRIPTION	APPROVER
8	7	6	5

