

|           |       |      |      |      |       |     |
|-----------|-------|------|------|------|-------|-----|
|           | 4     | 3    | 2    | 1    |       |     |
| Positions | A     | B    | C    | D    | F     | E   |
| 14        | 12.96 | 25.3 | 29.4 | 38.5 | 22.7  | 9.0 |
| 24        | 23.76 | 36.2 | 40.2 | 49.3 | 33.5  | 8.9 |
| 36        | 36.72 | 49.2 | 53.5 | 62.0 | 46.45 | 8.9 |
| 50        | 51.84 | 64.4 | 68.3 | 77.4 | 62.0  | 8.8 |

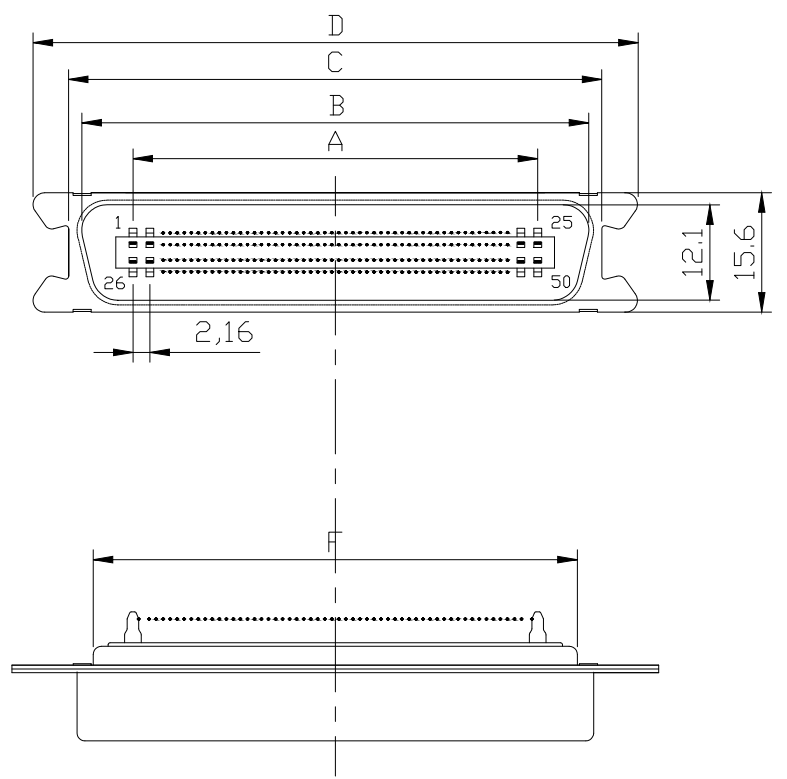

**ELECTRICAL CHARACTERISTICS**

Contact Current Rating: 5 Amp  
 Dielectric Withstanding Voltage: 500V AC  
 Insulation Resistance: 1000MΩ/Min  
 Contact Resistance: 35mΩ/Max  
 Operation Temperature: -25°C ~ +85°C

**PART NO:**

B17-0XX3X1A0-M2

**CONTACT NO.:**

14: 14PIN  
 24: 24PIN  
 36: 36PIN  
 50: 50PIN

**HOUSING COLOR:**

1:BLACK  
 6:BLUE

|      |             |                        |                                    |             |
|------|-------------|------------------------|------------------------------------|-------------|
| 4    | HOUSING     | PBT+G.F.30% (UL 94V-0) | COLOR:SEE PART NO.                 |             |
| 3    | REAR SHELL  | SPCC                   | PLATING:Sn                         |             |
| 2    | FRONT SHELL | SPCC                   | PLATING:Ni                         |             |
| 1    | TERMINAL    | COPPER ALLOY           | CONTACT AREA:G/F<br>SOLDER AREA:Sn |             |
| ITEM | DESC.       | MATERIAL               | REMAKS                             | PART REMAKS |

|      |            |             |           |
|------|------------|-------------|-----------|
| △    |            |             |           |
| △    |            |             |           |
| △    | 2012/11/06 | 新版发行        | King Zhou |
| SIDE | DATE       | DESCRIPTION | APPROVER  |
| 8    | 7          | 6           | 5         |

QUALITY SYMBOLS  
 □: CRITICAL MAJOR  
 ▽: ZERO DEFECT S.P.C

|           |       |
|-----------|-------|
| Tolerance |       |
| x.        | ±0.80 |
| .x        | ±0.50 |
| .xx       | ±0.30 |

|               |                      |       |            |   |           |                 |             |
|---------------|----------------------|-------|------------|---|-----------|-----------------|-------------|
| NAME:         | 57-简易公头焊线式MD型 (客户用图) |       |            |   | PART NO.  | B17-0XX3X1A0-M2 |             |
| REV:          | A                    | UNIT: | mm         | DRW BY  | CHK BY    | APP BY          | DRAWING NO. |
| SCALE:        | N:1                  | DATE: | 2012/11/06 | DAW NHU   | KING ZHOU |                 | B17-006     |
| 东莞市林诚塑胶电子有限公司 |                      |       |            | <a href="http://www.lineconn.com">http://www.lineconn.com</a><br>TEL:0769-85181660 85181770 |           |                 |             |
| 4             | 3                    | 2     | 1          |   |           |                 |             |