

PCB LAYOUT

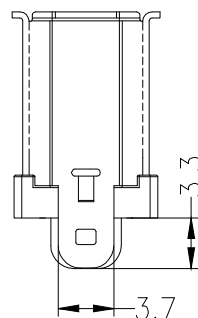
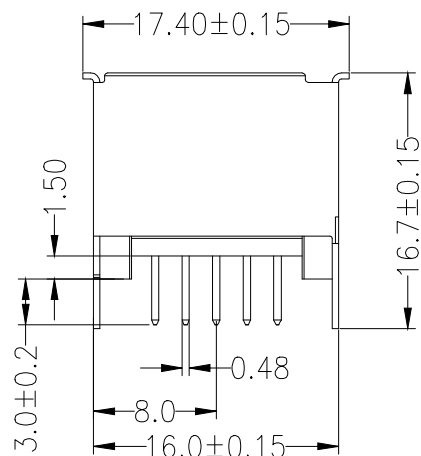
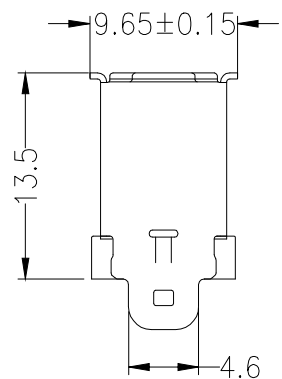

Voltage Current Rating: 1.5 AMP.
Dielectric Withstanding Voltage: 500V AC
 Insulation Resistance: 1000M Ω Min.
 Temperature Range: -25°C to +85°C

3	SHELL	COPPER ALLOY	PALTING: Ni	
2	HOUSING	PBT+30%GF	COLOR: BLACK	
1	TERMINAL	COPPER ALLOY	CONTACT AREA: G/F SOLDER AREA: G/F	
ITEM	DESC.	MATERIAL	REMARKS	PART REMARKS

QUALITY SYMBOLS

□: ☒: CRITICAL MAJOR
 ∇: ∇: ZERO DEFECT S.P.C

Tolerance
 .x ±0.50
 .x ±0.30
 .xx ±0.25

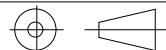

NAME:	SM 10P FEMALE直插 (客户用图)				PART NO.	B01-010813AN-01				
REV:	A	UNIT:	mm	DRW BY	CHK BY	APP BY	DRAWING NO.			
SCALE:	N:1	DATE:	2019/11/06	JINGLI	KING ZHOU		B05-026			
lineconn		东莞市林诚塑胶电子有限公司				http://www.lineconn.com				
						TEL:0769-85181660 85181770				

				QUALITY SYMBOLS	Tolerance	NAME:	SM 10P FEMALE直插 (客户用图)				PART NO.	B01-010813AN-01				
				□: ☒: CRITICAL MAJOR	.x ±0.50 .x ±0.30 .xx ±0.25	REV:	A	UNIT:	mm	DRW BY	CHK BY	APP BY	DRAWING NO.			
△	2019/11/06	NEW ISSUE		JINGLI		SCALE:	N:1	DATE:	2019/11/06	JINGLI	KING ZHOU		B05-026			
SIDE	DATE	DESCRIPTION		APPROVER		lineconn		东莞市林诚塑胶电子有限公司				http://www.lineconn.com				
												TEL:0769-85181660 85181770				