

PCB Layout

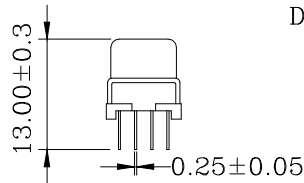

• ELECTRICAL CHARACTERISTICS

- Contact Current Rating: 1 Amp
- Dielectric Withstanding Voltage: 500V AC
- Insulation Resistance: 500MΩ/Min
- Contact Resistance: 35mΩ/Max
- Operation Temperature: -25°C ~ +85°C

3	HOUSING	PBT+G.F.30% (UL 94V-0)	COLOR: BLACK	
2	SHELL	SPCC	PLATING: Ni	
1	TERMINAL	PHOSPHOR BRONZE	CONTACT AREA: Au 5u" SOLDER AREA: Sn UNDER-PLATING: Ni	
ITEM	DESC.	MATERIAL	REMARKS	PART REMARKS

△				QUALITY SYMBOLS
△				□: ⊠:
△	2009/06/12新版发行		King Zhou	CRITICAL MAJOR
SIDE	DATE	DESCRIPTION	APPROVER	▽: ▽:
8	7	6	5	ZERO DEFECT S.P.C

Tolerance		NAME: SCS1 100P MALE 180° DIP (客户用图)			PART NO.	B03-100711EN-01			
x.	±0.80	REV:	A	UNIT:	mm	DRW BY	CHK BY	APP BY	DRAWING NO.
.x	±0.50	SCALE:	N:1	DATE:	2009/06/12	JACK CHEN	DEAN FAN		B03-067
.xx	±0.30	lineconn 东莞市林诚塑胶电子有限公司			http://www.lineconn.com			TEL:0769-85181660 85181770	

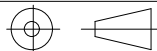

lineconn 东莞市林诚塑胶电子有限公司 http://www.lineconn.com
TEL:0769-85181660 85181770