

- Current Rating: 1 Amp
- Insulation Resistance: 500MΩ/Min
- Withstanding Voltage: 500V AC/Min
- Contact Resistance: 35mΩ Max
- Temperature Range: -25°C ~ +85°C

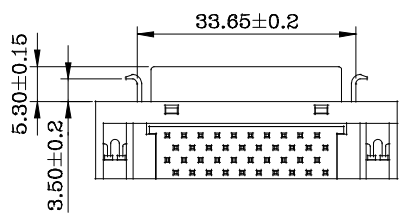

L Type

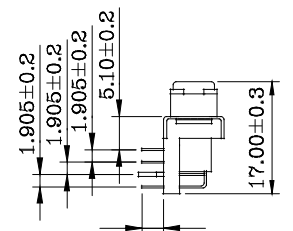

S Type

PART NO:  
B03-040611EB-0X

BRACKET FINISHES:

L:LATCH BRACKET

S:SCREW BRACKET

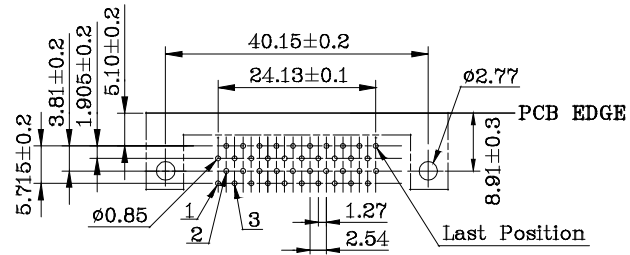

PCB Layout

6	BOARDLOCK	COPPER ALLOY	PLATING: Tin	
5	BRACKET	SPCC	PLATING: Ni	
4	COVER	PBT+30%GF	COLOR: BLACK	
3	HOUSING	PBT+30%GF	COLOR: BLACK	
2	SHELL	SPCC	PLATING: Ni	
1	TERMINAL	PHOSPHOR BRONZE	CONTACT AREA: Au 5u" SOLDER AREA: Sn UNDER-PLATING: Ni	
ITEM	DESC.	MATERIAL	REMARKS	PART REMARKS

				QUALITY SYMBOLS	Tolerance	NAME:	SCSI 40P FEMALE 90度 DIP (客户用图)			PART NO.	<b>B03-040611EB-0X</b>		
				□:    ☒:	x.    ±0.50	REV:	A	UNIT:	mm	DRW BY	CHK BY	APP BY	DRAWING NO.
				CRITICAL MAJOR	.x    ±0.30	SCALE:	N:1	DATE:	2010/10/11	JINGLI	KING ZHOU		<b>B03-021</b>
				▽:    ▽:	.xx   ±0.25								
SIDE	DATE	DESCRIPTION	APPROVER	ZERO DEFECT S.P.C									
8	7	6	5	4	3	2	1						

**东莞市林诚塑胶电子有限公司**
<http://www.lineconn.com>  
 TEL: 0769-85181660 85181770