

L Type



S Type

Thread Hole
(2 Places)

- Current Rating: 1 Amp
- Insulation Resistance: 500MΩ/Min
- Withstanding Voltage: 500V AC/Min
- Contact Resistance: 35mΩ Max
- Temperature Range: -25°C ~ +85°C

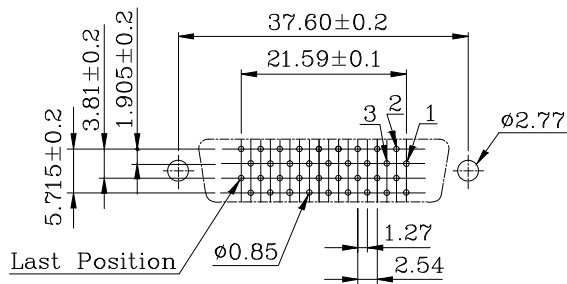
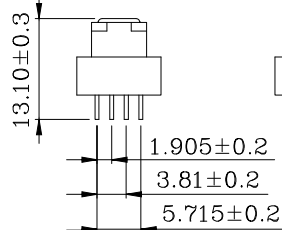
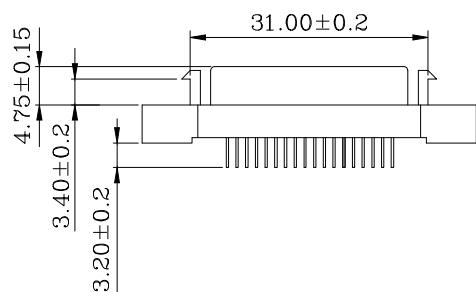

PCB Layout (B)

PART NO:
B02-036818EC-2X

BRACKET FINISHES:

L:LATCH BRACKET

S:SCREW BRACKET

3	HOUSING	PBT+30%GF	COLOR:BLACK
2	SHELL	ZINC ALLOY	PLATING:Ni
1	TERMINAL	PHOSPHOR BRONZE	CONTACT AREA:Au 5u" SOLDER AREA:Sn UNDER-PLATING:Ni
ITEM	DESC.	MATERIAL	REMAKS

QUALITY SYMBOLS

□: CRITICAL
▽: ZERO DEFECT
⊗: MAJOR
▽: S.P.C

Tolerance

x. ±0.50
.x ±0.30
.xx ±0.25

NAME:

SCSI PIN TYPE 36P F 180° DIP
(客户用图)

PART NO.

B02-036818EC-2X

REV:

A

UNIT:

mm

DRW BY

CHK BY

APP BY

DRAWING NO.

SCALE:

N:1

DATE:

2008/07/04

JACK CHEN

DEAN FAN

B02-002

lineconn

东莞市林诚塑胶电子有限公司

http://www.lineconn.com
TEL: 0769-85181660 85181770

△

2008/07/04

NEW ISSUE

JACK CHEN

SIDE

DATE

DESCRIPTION

APPROVER

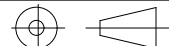

东莞市林诚塑胶电子有限公司

http://www.lineconn.com
TEL: 0769-85181660 85181770