

U92 - A411 - 1X01 - 7X

OPTIONAL DUST COVER

- 0** - NO DUST COVER
- D** - WITH DUST COVER (SHIPPED BULK IN SAME BOX WITH CAGE & CONNECTOR ASSEMBLY)

MOUNTING SCREWS

- 0** - NO MOUNTING SCREWS SHIPPED
- 1** - WITH MOUNTING SCREWS M2 X 04 - 4.3 MM LONG SHIPPED BULK IN SAME TRAY WITH CAGE ASSEMBLIES

CONTACT PLATING

MATING AREA PLATING: 0.76 µm GOLD OVER 1.27 µm TO 3.81 µm OF NICKEL
 PRESS FIT TAIL AREA PLATING: 0.381 µm TO 1.52 µm OF MATTE TIN OVER 1.27 µm TO 3.81 µm OF NICKEL
 (RoHS COMPLIANT PER RoHS DIRECTIVE 2011/65/EU.)

REVISIONS			
REV.	DESCRIPTION	DATE	APPROVED
A	PROPOSAL	MAY 09/13	ZLJ
B	PCB DIMENSION ADDED	AUG 7/13	ZLJ
C	CHANGE THE BOTTOM GUARD CAGE	SEP 24/13	ZLJ

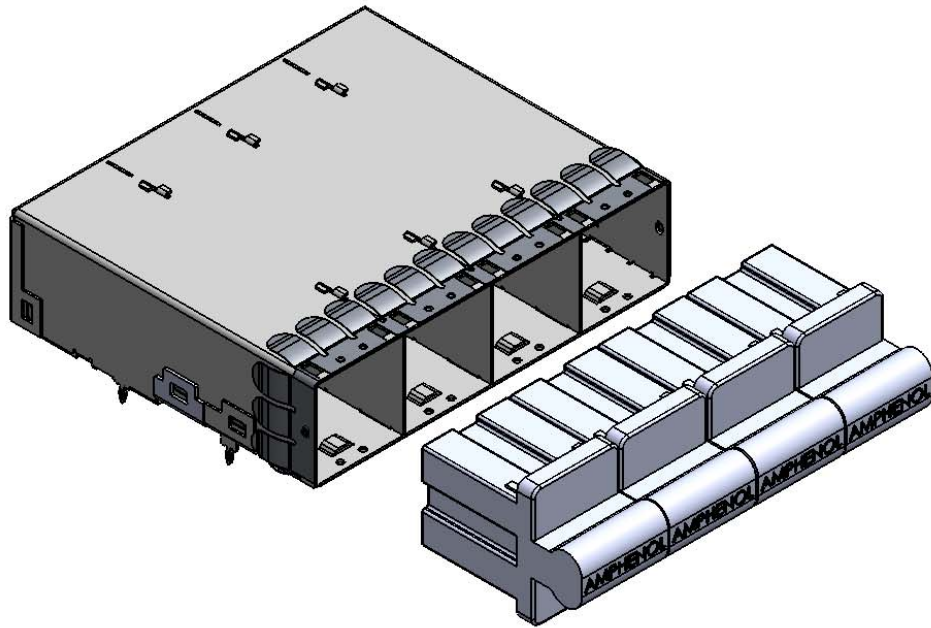

PART # **U92-A411-1D01-70** SHOWN
 (CAGE & CONNECTOR ASSEMBLY WITH NO SCREWS AND DUST COVER SHIPPED BULK)

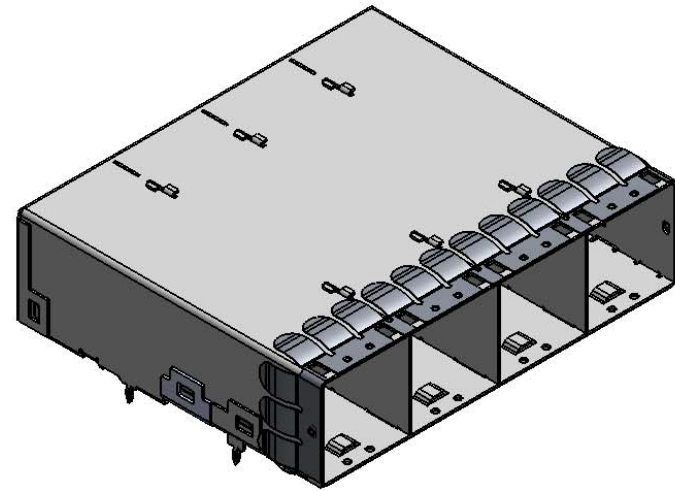

PART # **U92-A411-1001-70** SHOWN
 (CAGE & CONNECTOR ASSEMBLY WITH NO SCREWS AND NO DUST COVER SHIPPED)

UNLESS OTHERWISE SPECIFIED: DIMENSIONS ARE IN MILLIMETERS TOLERANCES ARE:		APPROVAL	DATE	Amphenol High Speed Interconnects A Division of Amphenol Corp. www.amphenol-highspeed.com 12GBPS-16X MINI SAS HD CAGE & CONNECTOR 4 PORT ASSEMBLY WITH LONG EMI FINGERS
DECIMALS	ANGLES	DRAWN: Mike.H	MAY 09/13	
.X ±0.2	X° ±1°	CHECKED: ZLJ	MAY 09/13	
.XX ±0.1	X.X° ±0.5°	QA APPR:		
		ME APPR:		
		DWG APPR: ZLJ	MAY 09/13	
 DO NOT SCALE DRAWING		ENG. REL. NO.		SIZE: DWG. NO.: P-U92-A411-1X01-7X REV: C
		NSCM:		SCALE: 1:1 PROJECT: HD SHEET 1 OF 4

8

7

6

5

4

3

2

1

REVISIONS			
REV.	DESCRIPTION	DATE	APPROVED
C	SEE SHEET ONE	SEP 24/13	ZLJ

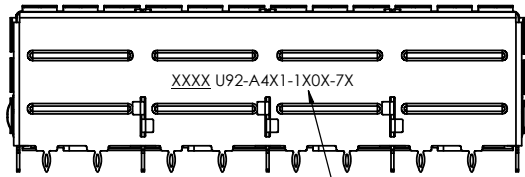
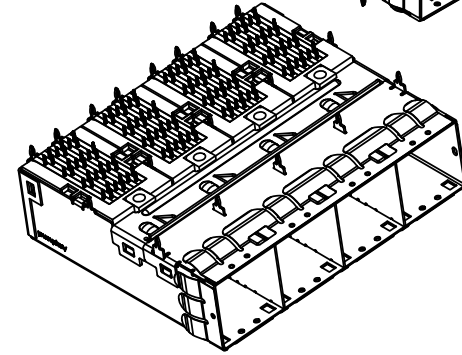
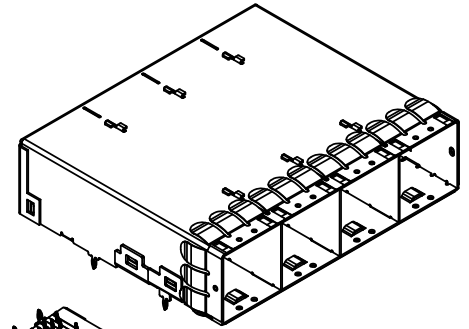
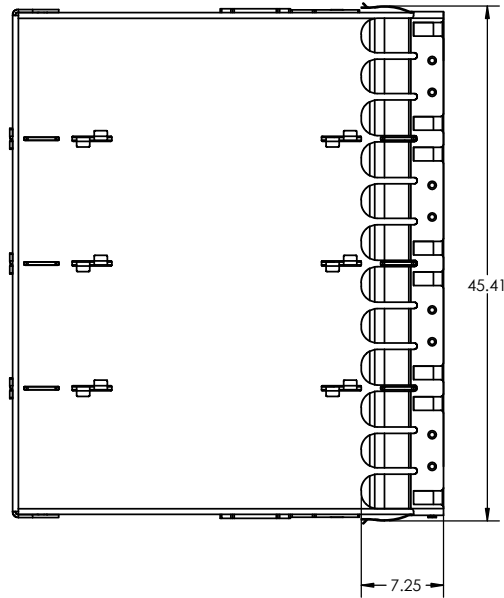

INK MARKING INFO:
FOUR (4) DIGIT DATE CODE AND PART NUMBER

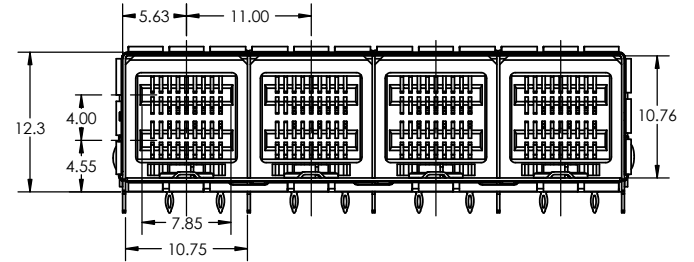
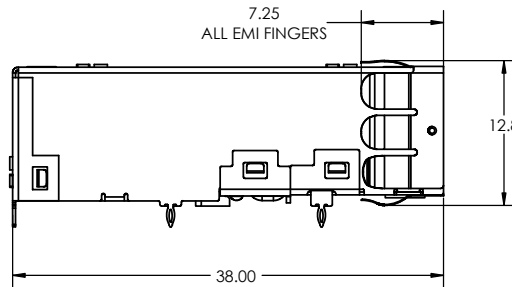

UNLESS OTHERWISE SPECIFIED:
DIMENSIONS ARE IN MILLIMETERS
TOLERANCES ARE:

DECIMALS	ANGLES
.X ±0.2	X° ±1°
.XX ±0.1	X.X° ±0.5°

APPROVAL	DATE
DRAWN: Mike.H	MAY 09/13
CHECKED: ZLJ	MAY 09/13
QA APPR:	
ME APPR:	
DWG APPR: ZLJ	MAY 09/13

Amphenol High Speed Interconnects
A Division of Amphenol Corp. www.amphenol-highspeed.com

**12GBPS-16X MINI SAS HD
CAGE & CONNECTOR
4 PORT ASSEMBLY
WITH LONG EMI FINGERS**

DO NOT SCALE DRAWING

ENG. REL. NO.
NSCM:

SIZE	DWG. NO.	REV
SCALE: 2:1	P-U92-A411-1X01-7X	C
PROJECT: HD	SHEET 2 OF 4	

8

7

6

5

4

3

2

1

REVISIONS			
REV.	DESCRIPTION	DATE	APPROVED
C	SEE SHEET ONE	SEP 24/13	ZLJ

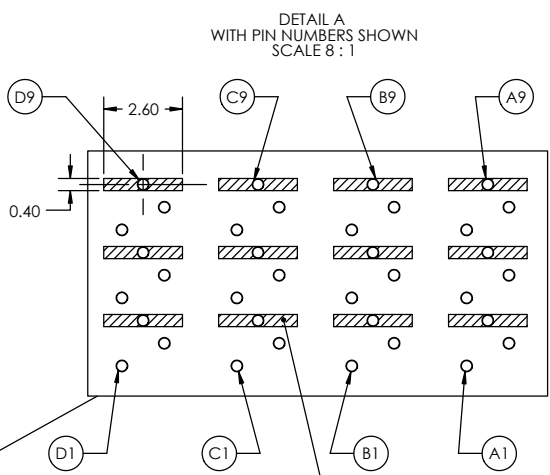
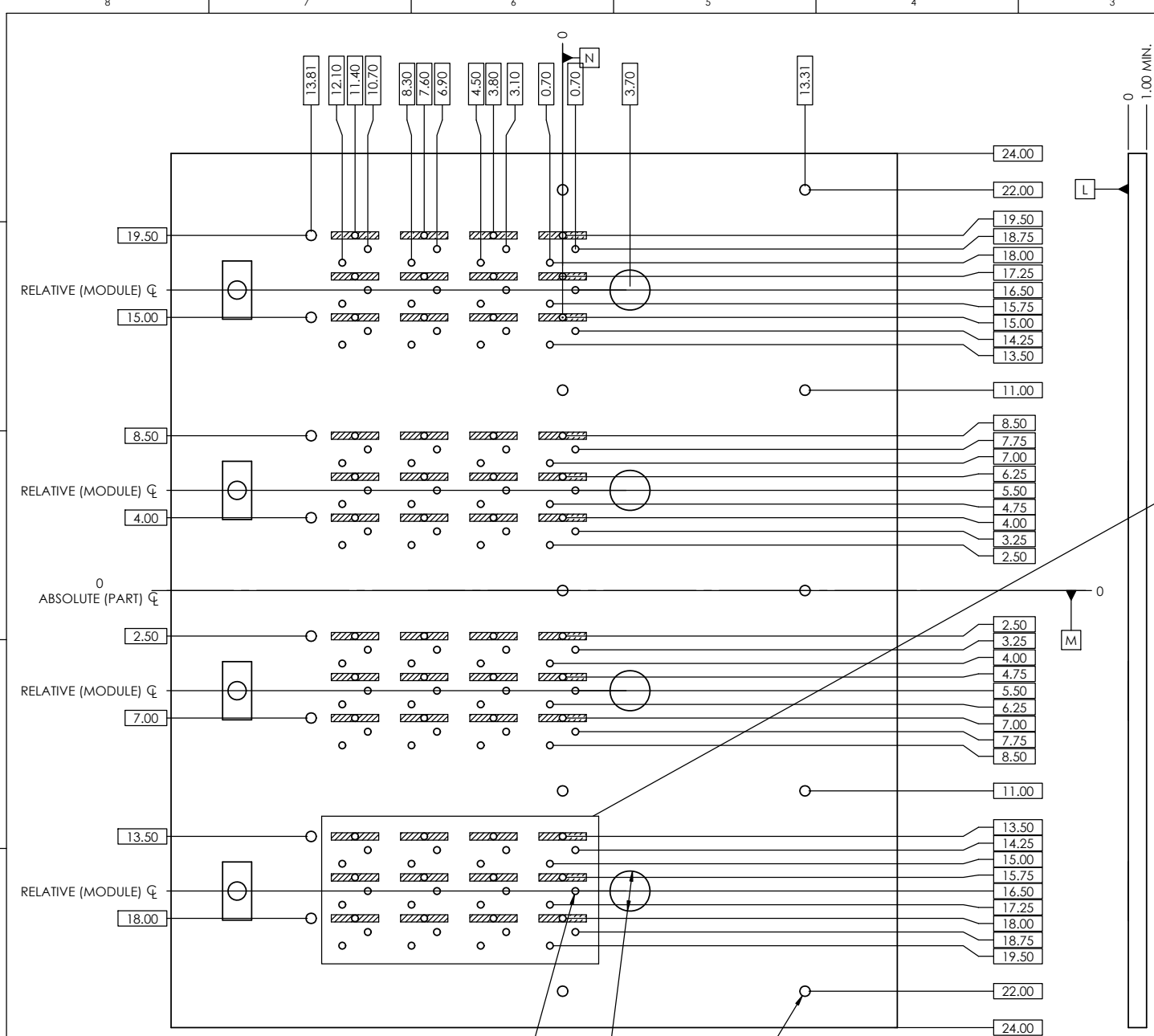

CROSS-HATCHED AREA DENOTES COMPONENT AND TRACE KEEP-OUT

- NOTES:
1. ALL HOLES MUST FALL WITHIN POSITIONAL TOLERANCES RELATIVE TO INDIVIDUAL CONNECTOR ASSEMBLY AS WELL AS COMPLETED CAGE ASSEMBLY.
 2. DATUM M AND N ESTABLISHED BY CUSTOMER'S FUDICIAL.
 3. ALL HOLE DIMENSIONS DENOTE FINISHED HOLE SIZES.

144 X $\varnothing 0.37 \pm 0.05$
 $\varnothing 0.05$ L M
 $\varnothing 0.05$ REL. C (SEE NOTE 1)

4 X $\varnothing 2.20$
 $\varnothing 0.05$ L M N

18 X $\varnothing 0.57 \pm 0.05$
 $\varnothing 0.05$ L M N
 $\varnothing 0.05$ REL. C (SEE NOTE 1)

RECOMMENDED 4 PORT MOUNT
 PCB LAYOUT
 COMPONENT SIDE SHOWN

UNLESS OTHERWISE SPECIFIED: DIMENSIONS ARE IN MILLIMETERS TOLERANCES ARE:		APPROVAL	DATE
DECIMALS	ANGLES	Mike.H	MAY 09/13
.X ± 0.2	X° $\pm 1^\circ$	CHECKED	MAY 09/13
.XX ± 0.1	X.X° $\pm 0.5^\circ$	GA APPR.	
		ME APPR.	
		DWG APPR.	MAY 09/13
		ENG. REL. NO.	
		NSCM:	

Amphenol High Speed Interconnects
 A Division of Amphenol Corp. www.amphenol-highspeed.com

**12GBPS-16X MINI SAS HD
 CAGE & CONNECTOR
 4 PORT ASSEMBLY
 WITH LONG EMI FINGERS**

SIZE	DWG. NO.	P-U92-A411-1X01-7X	REV	C
SCALE:	2:1	PROJECT:	HD	SHEET 3 OF 4

REVISIONS			
REV.	DESCRIPTION	DATE	APPROVED
C	SEE SHEET ONE	SEP 24/13	ZLJ

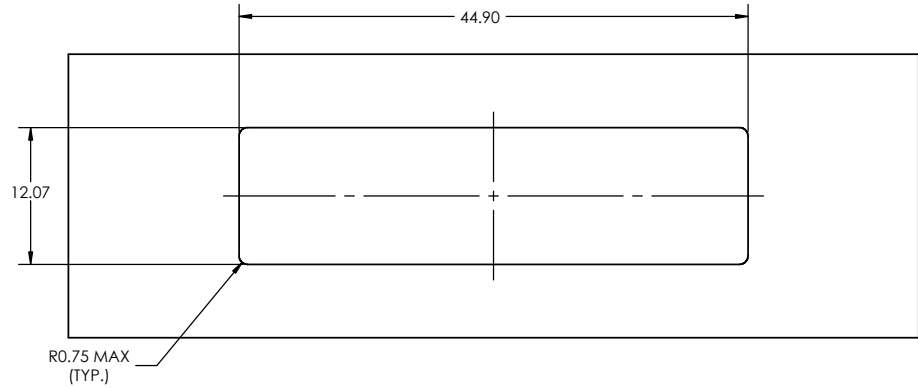

RECOMMENDED PANEL CUTOUT FOR SINGLE LEVEL MOUNTING

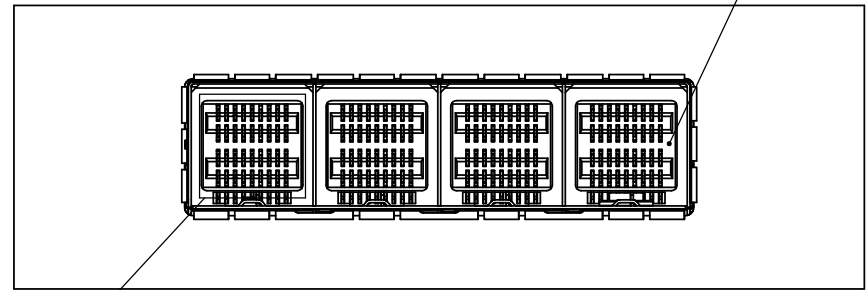
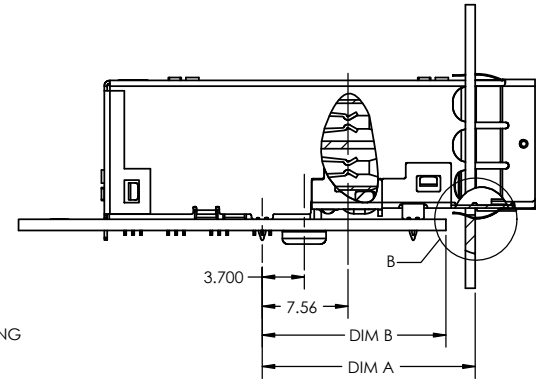
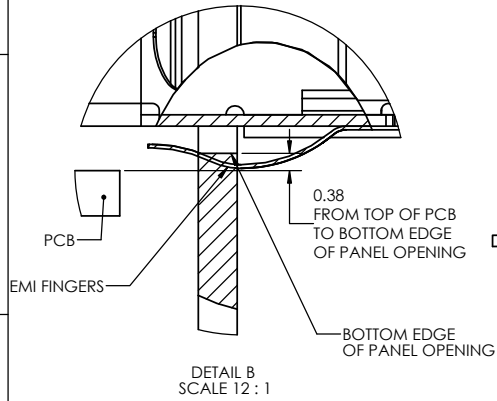
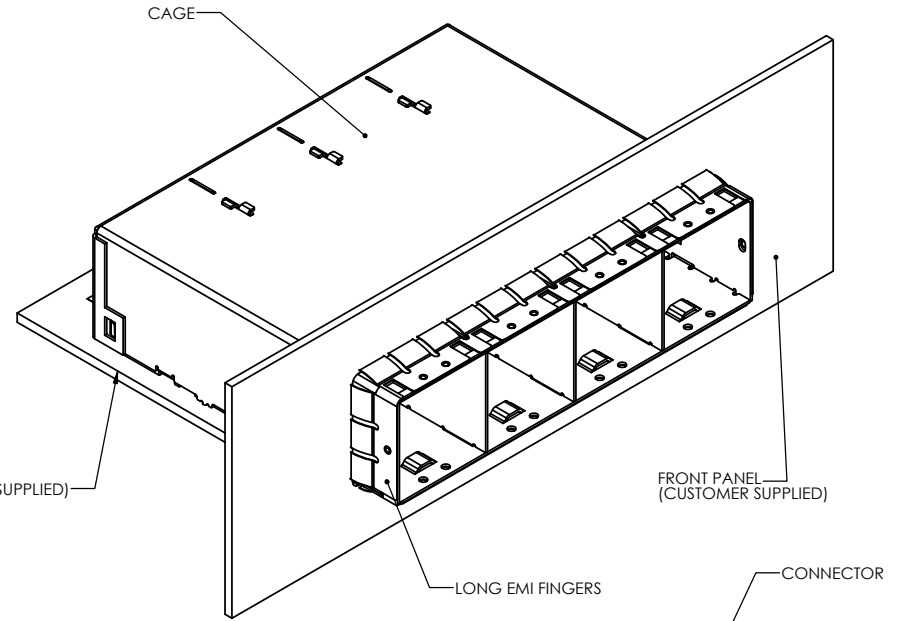

APPLICATION	DIM A	DIM B
OTHER M/B BRACKET	20.08	18.19
PCI BRACKET	19.00	17.10

NOTES:

- MATERIAL
 - MAIN CAGE: PHOSPHOR BRONZE WITH NICKEL PLATING
 - MOUNTING SCREW: AISI 1010 STEEL
 - CONNECTOR HOUSING: LCP
 - CONTACTS: PHOSPHOR BRONZE, FOR PLATING INFO. SEE SHEET ONE
- CONNECTOR AND CAGE ASSEMBLY ARE RoHS COMPLIANT

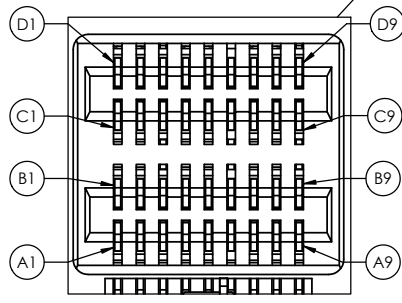

DETAIL VIEW WITH PIN NUMBERS SHOWN SCALE 8 : 1

UNLESS OTHERWISE SPECIFIED: DIMENSIONS ARE IN MILLIMETERS TOLERANCES ARE:		APPROVAL	DATE
DECIMALS	ANGLES	Mike.H	MAY 09/13
.X ±0.2	X° ±1°	CHECKED	ZLJ
.XX ±0.1	X.X° ±0.5°	QA APPR.	MAY 09/13
 DO NOT SCALE DRAWING		ME APPR.	
		DWG APPR.	ZLJ
		ENG. REL. NO.	MAY 09/13
		NSCM:	

Amphenol High Speed Interconnects
 A Division of Amphenol Corp. www.amphenol-highspeed.com

12GBPS-16X MINI SAS HD CAGE & CONNECTOR 4 PORT ASSEMBLY WITH LONG EMI FINGERS

SIZE	DWG. NO.	P-U92-A411-1X01-7X	REV	C
SCALE: 1:1	PROJECT: HD	SHEET 4 OF 4		