

8 7 6 5 4 3 2 1

F F

E E

D D

C C

B B

A A

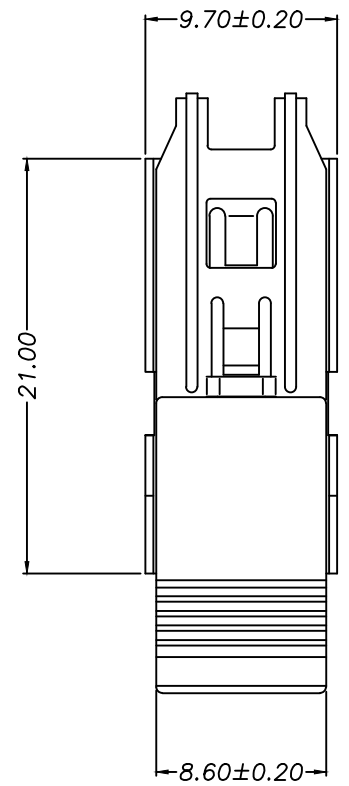
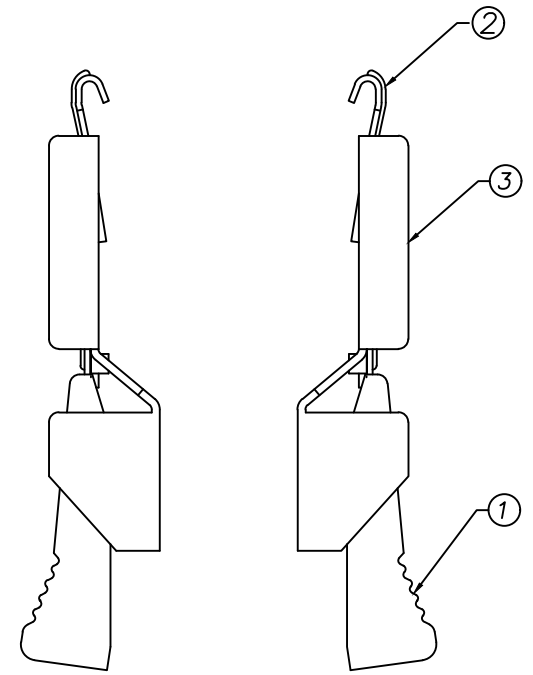

• **ELECTRICAL CHARACTERISTICS**

Contact Current Rating: 1 Amp
 Dielectric Withstanding Voltage: 500V AC
 Insulation Resistance: 500MΩ/Min
 Contact Resistance: 35mΩ/Max
 Operation Temperature: -55°C ~ +105°C

• **PART NO.:**

B03-0003X11N-01

COLOR:
 1:BLACK
 2:GRYA

3	CLENCH PATCH	STEEL (T=0.50mm)	PLATING:SEE NOTE	
2	WRENCH SPRING LEAF	SUS 304(T=0.30mm)	PLATING:SEE NOTE	
1	WRENCH HOUSING	ABS	COLOR:SEE NOTE	
ITEM	DESC.	MATERIAL	REMAKS	PART REMAKS

A	△	2013/07/25	修正弹片材质, 依新料号编码原则变更料号	Huaping Guan	QUALITY SYMBOLS □: ☒: CRITICAL MAJOR ▽: ▽: ZERO DEFECT S.P.C	Tolerance x. ⌀0.50 .x ⌀0.30 .xx ±0.25	NAME: SCS1 MOLDED TYPE鱼钩型弹片 (客户用图)				PART NO.	B03-0003X11N-01		
	△	2011/09/07	增加特性描述, 修正品名	King Zhou			REV:	E	UNIT:	mm	DRW BY	CHK BY	APP BY	DRAWING NO.
	△	2007/10/18	新版发行	King Zhou			SCALE:	N:1	DATE:	2007/10/18	DAWN HU	KING ZHOU		B03-033
	SIDE	DATE	DESCRIPTION	APPROVER			Lineconn 东莞市林诚塑胶电子有限公司 http://www.lineconn.com TEL:0769-85181660 85181770							

8 7 6 5 4 3 2 1