

PCB LAYOUT

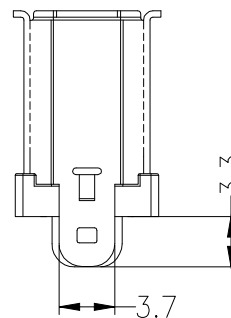
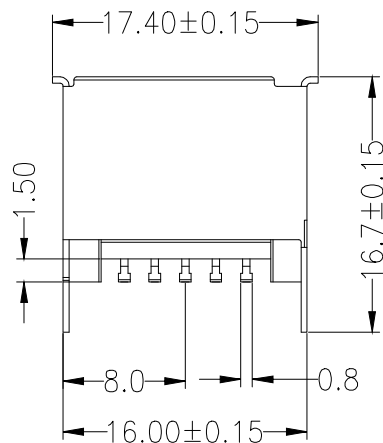
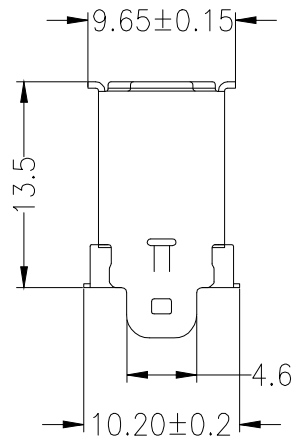

Voltage Current Rating: 1.5 AMP.
Dielectric Withstanding Voltage: 500V AC
 Insulation Resistance: 1000MΩ Min.
 Temperature Range: -25°C to +85°C

3	SHELL	COPPER ALLOY	PALTING: Ni	
2	HOUSING	PBT+30%GF	COLOR: BLACK	
1	TERMINAL	COPPER ALLOY	CONTACT AREA: G/F	
			SOLDER AREA: G/F	
ITEM	DESC.	MATERIAL	REMARKS	PART REMARKS

QUALITY SYMBOLS

□: ☒: CRITICAL MAJOR
 ▽: ▽: ZERO DEFECT S.P.C

Tolerance

x. ±0.50
 .x ±0.30
 .xx ±0.25

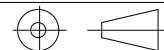

NAME:

SM 10P FEMALE 直立式SMT (客户用图)

REV:

A

UNIT:

mm

DRW BY

CHK BY

APP BY

DRAWING NO.

SCALE:

N:1

DATE:

2019/11/06

JINGLI

KING ZHOU

B05-025

lineconn

东莞市林诚塑胶电子有限公司

http://www.lineconn.com

TEL: 0769-85181660 85181770

△	2019/11/06	NEW ISSUE	JINGLI	
SIDE	DATE	DESCRIPTION	APPROVER	
8	7	6	5	4

3 2 1